

2" x 2"



Ideal for medium- to heavy-duty construction. 2" x 2" profile has eight #8 T-slots and is used with other #8 accessories and fasteners in this catalog.

Minimum length: 1.25"

Maximum length: 240"

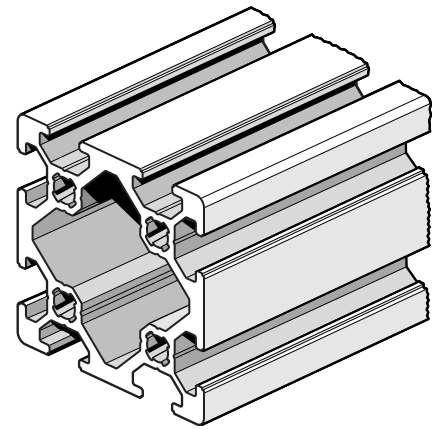

**Technical Data**

Moment of inertia	$I_x = 0.554 \text{ in}^4$ $I_y = 0.554 \text{ in}^4$
Section modulus	$W_x = 0.554 \text{ in}^3$ $W_y = 0.554 \text{ in}^3$
Profile surface	$A = 1.226 \text{ in}^2$
Weight	1.434 lbs/ft

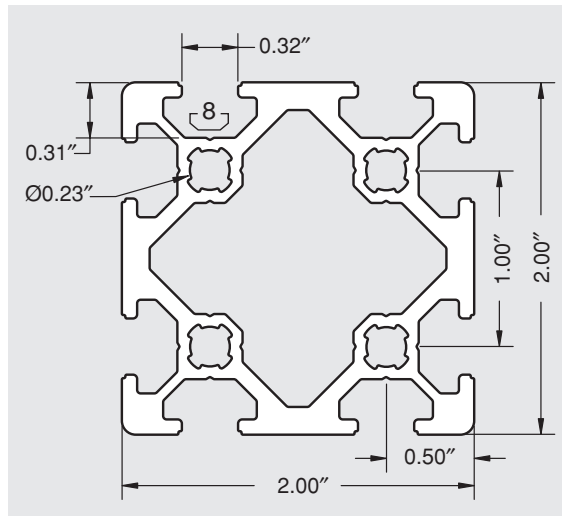

Description	End Machining	Part Number
Profile 2x2, Pkg. 20, 240" long		8 981 021 391
Profile 2x2, single, 240" long		8 981 021 400
Profile 2x2, -/-, Single, square cut to length, $\geq 1.25" \leq 240"$		8 981 992 332/___in*
Profile 2x2, -/D <sup>5</sup> / <sub>16</sub> , Single, $\geq 1.25" \leq 240"$		8 981 992 333/___in*
Profile 2x2, -/D <sup>33</sup> / <sub>64</sub> , Single, $\geq 1.25" \leq 240"$		8 981 992 334/___in*
Profile 2x2, D <sup>5</sup> / <sub>16</sub> /D <sup>5</sup> / <sub>16</sub> , Single, $\geq 1.50" \leq 240"$		8 981 992 335/___in*
Profile 2x2, D <sup>33</sup> / <sub>64</sub> /D <sup>33</sup> / <sub>64</sub> , Single, $\geq 2.50" \leq 240"$		8 981 992 336/___in*
Profile 2x2, D <sup>33</sup> / <sub>64</sub> /D <sup>33</sup> / <sub>64</sub> VS, Single, $\geq 2.50" \leq 240"$		8 981 992 337/___in*
Profile 2x2, -/¼-20, Single, $\geq 2.50" \leq 240"$		8 981 992 404/___in*
Profile 2x2, D <sup>5</sup> / <sub>16</sub> /¼-20, Single, $\geq 2.50" \leq 240"$		8 981 992 405/___in*

\*Specify length in 1/16" increments