

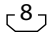

Section 2: Profiles

2

30x45°R  

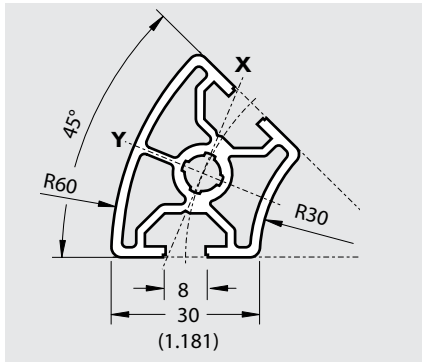

Features:

- Provides high-tech appearance
- Curved surfaces ideal for following machine or space contours
- Has two 8mm T-slots

Non-Machined End Finish Options

Non-Machined End Finish Options	Part Number
Profile 30x45°R, pkg. of 20, 5600mm long	3 842 524 034
Profile 30x45°R, single, 5600mm long	3 842 524 033

Machined Options

Profile 30x45°R, -/-, specify length $\geq 30\text{mm} \leq 5600\text{mm}$



End Finish



Part Number

3 842 993 011/ __mm

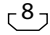
Please contact your distributor for other machining options.

30x60°R  

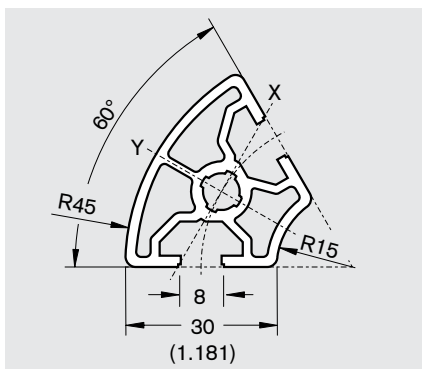

Features:

- Provides high-tech appearance
- Curved surfaces ideal for following machine or space contours
- Has two 8mm T-slots

Non-Machined End Finish Options

Non-Machined End Finish Options	Part Number
Profile 30x60°R, pkg. of 20, 5600mm long	3 842 524 037
Profile 30x60°R, single, 5600mm long	3 842 524 036

Machined Options

Profile 30x60°R, -/-, specify length $\geq 30\text{mm} \leq 5600\text{mm}$

End Finish



Part Number

3 842 993 012/ __mm

Please contact your distributor for other machining options.

30x45  

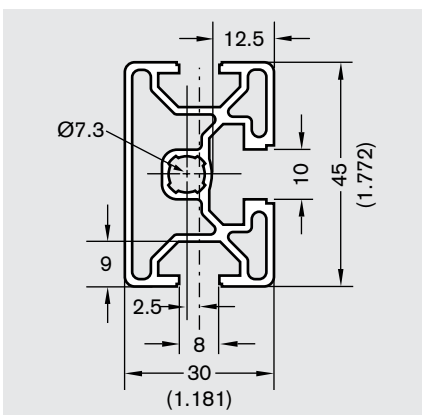

Features:

- Ideal for intermediate connection between 8mm and 10mm T-slotted profiles
- Has two 8mm T-slots and one 10mm T-slot

Non-Machined End Finish Options

Non-Machined End Finish Options	Part Number
Profile 30x45, pkg. of 18, 5600mm long	3 842 511 704
Profile 30x45, single, 5600mm long	3 842 511 703

Machined Options

Profile 30x45, -/-, specify length $\geq 30\text{mm} \leq 5600\text{mm}$

End Finish



Part Number

3 842 992 430/ __mm

Profile 30x45, M8/-, specify length $\geq 40\text{mm} \leq 5600\text{mm}$



3 842 992 431/ __mm

Please contact your distributor for other machining options.